

## STEP 1

- ITEM A : DRL HARNESS
- ITEM B : BATTERY HARNESS
- ITEM C : RESISTORS

Connect DRL HARNESS to each INLINE HEADLIGHT HARNESS.

*NOTE: DRL HARNESS WITH TWO SINGLE CONNECTORS IS PASSENGER/RIGHT SIDE*

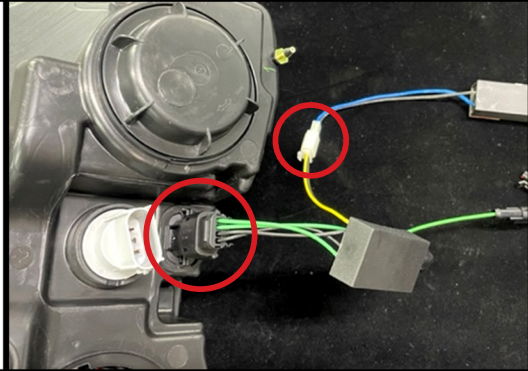
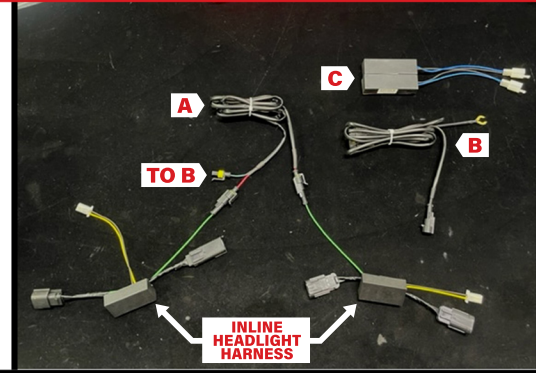

## STEP 2

Connect female side of INLINE HEADLIGHT HARNESS to main headlight connector on headlight as shown in big circle.

Connect resistor to DRL HARNESS as shown in little circle.

Use double-sided tape on resistor to attach onto metal surface on vehicle (resistor can get hot).

## STEP 3

Route DRL HARNESS using supplied zip ties on radiator support brace. Connect circled male side of INLINE HEADLIGHT HARNESS to factory vehicle main headlight connector.

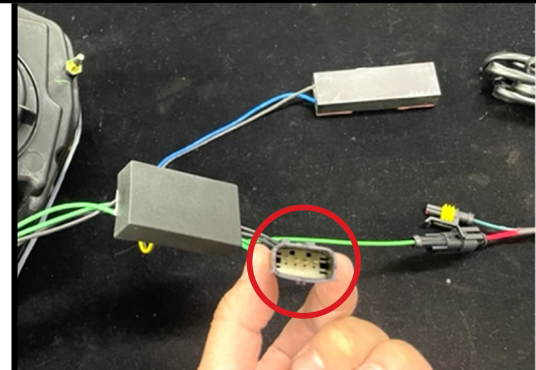

## STEP 4

Connect BATTERY HARNESS to DRL HARNESS as shown.



## STEP 5

Route BATTERY HARNESS using supplied zip ties. Connect C-shaped clamp connector to positive (+) side of battery.

Test functions of headlights before driving on the road.

